

# INSTRUCTION MANUAL MANUAL DE INSTRUCCIONES MANUEL DE L'UTILISATEUR

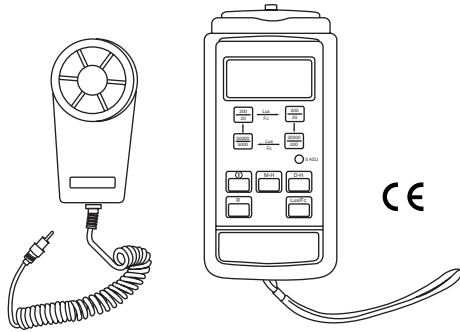

93-172  
DIGITAL LIGHT METER

93-172  
FOTÓMETRO DIGITAL

LUXMÈTRE NUMÉRIQUE

93-172



**Read and understand** all of the instructions and safety information in this manual before operating or servicing this tool.

**Lea y entienda** todas las instrucciones y normas de seguridad incluidas en este manual, antes de manejar esta herramienta o darle mantenimiento.

Nous vous conseillons de **lire attentivement** et de **bien comprendre** les instructions suivantes avant d'utiliser ou de procéder à l'entretien de cet outil. Le non-respect d'une telle consigne peut entraîner des blessures corporelles ou même la mort.

## Description

The Greenlee 93-172 is a digital light meter intended to measure light emitted from fluorescent, metal halide, high-pressure sodium and incandescent light sources.

## Safety

Safety is essential in the use and maintenance of Greenlee tools and equipment. This instruction manual and any decals on the tool provide information for avoiding hazards and unsafe practices related to the use of this tool. Observe all of the safety information provided.

## Purpose

This manual is intended to familiarize personnel with the safe operation and maintenance procedures for the Greenlee 93-172 Digital Light Meter.

Keep this manual available to all personnel.

Replacement manuals are available upon request at no charge.

and **GREENLEE** are registered trademarks of Greenlee Textron.

## CAUTION

Do not expose test instrument to extremes in temperature or high humidity. See Specifications section of this manual.

Failure to observe these precautions can result in injury and can damage the instrument.

## IMPORTANT

Replace weak or discharged batteries as soon as either of these conditions is detected.

## Specifications

### Ranges

Footcandles ..... 20 / 200 / 2000 / 5000  
Lux ..... 200 / 2000 / 20,000 / 50,000

### Accuracy

Incandescent Light Source ..... ± 4%  
Other Light Source ..... ± 7%

Temperature Range ..... 0° – 40° C (32° – 104° F)

Relative Humidity ..... Less Than 80%

Power ..... One 9-Volt Battery

## Operation

1. Plug the sensor into the sensor jack.
2. Press the button.
3. Press the **Lux/Fc** selector to select either lux or footcandles.
4. Press the **R** button to select the appropriate measurement range.  
*Note: Set the display to 000 by twisting the zero adjustment screw.*
5. Place the sensor at the measurement location and remove the cover. Read the display.

### Additional Notes:

- If the display reads **OL**, switch to the next higher range.
- When the display reads **X 10**, multiply the reading on the display by 10 for the actual value.
- When the display reads **X 100**, multiply the reading on the display by 100 for the actual value.
- To store a reading on the display, press **D-H** (Data Hold). Press **D-H** again to resume normal measuring.
- To store a maximum or peak reading, press **M-H**. Press **M-H** again to resume normal measuring.

## Maintenance

### General

- Keep the tester clean and dry.
- When necessary, wipe clean with a damp cloth. Allow the tester to dry completely before use.

### Battery Replacement

1. Loosen screw on the back of the meter.
2. Remove the battery door.
3. Replace the battery.
4. Install the battery door.

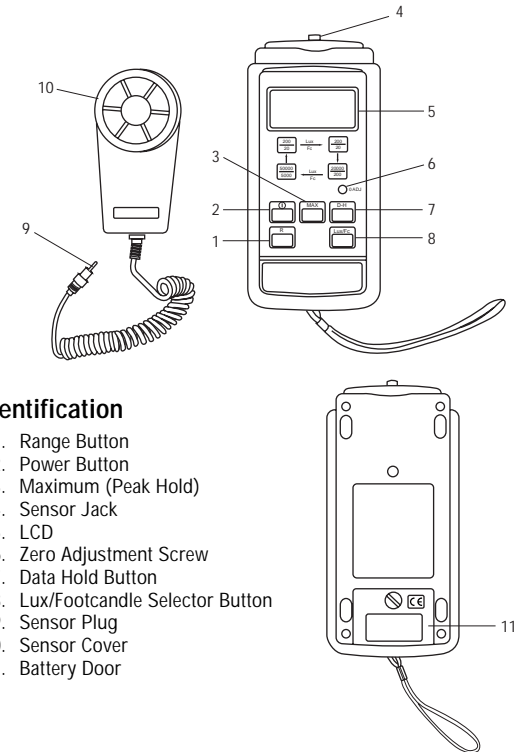

## Identification

1. Range Button
2. Power Button
3. Maximum (Peak Hold)
4. Sensor Jack
5. LCD
6. Zero Adjustment Screw
7. Data Hold Button
8. Lux/Footcandle Selector Button
9. Sensor Plug
10. Sensor Cover
11. Battery Door

## Identificación

1. Botón Range (margen)
2. Botón Power (encendido)
3. Botón Peak Hold (guardar valor máximo)
4. Receptáculo del sensor
5. Pantalla de cristal líquido (LCD)
6. Tornillo de ajuste en ceros
7. Botón Data Hold (guardar datos)
8. Botón selector de luxios/bujías-pies
9. Clavija de conexión del sensor
10. Tapa del sensor
11. Tapa del compartimiento de las pilas

## Identification

1. Bouton de gamme
2. Bouton Marche/Arrêt
3. Maximum (maintien de la crête)
4. Jack du capteur
5. Affichage à cristaux liquides
6. Vis de réglage sur 0
7. Bouton de maintien des données
8. Bouton de sélection lux/bougie pied
9. Prise du capteur
10. Couverture du capteur
11. Couverture du boîtier de la pile

## Parts

UPC No.	Part No.	Description	Qty
78-3310-			
06061	500 6061.9	Sensor .....	1
06083	500 6083.0	Sensor Cover .....	1
06200	500 6200.0	Case .....	1